

STAGE DECK RANGE

STAGE DECK PROPERTIES

Upper Rails	40 x 20 x 3 RHS
Lower Rails	20 x 20 x 3 SHS
Webs	10mm Round Bar
Corners	63.5 x 63.5 x 4.4 SHS

Note:

1. All frame & truss is Aluminum Alloy 6061 T6
2. Weld Material 5356
3. Deck timber Australian Form Ply (grade F14) 17mm
4. Legs material: Galvanised Steel Light Pipe 48.3 x 2.8mm

STAGE DECK RATING

2400mm x 1200mm Stage Deck rated for 750kg/m² live load
Structural Engineering from Bking Consulting P/L

STAGE DECK SIZES - Rectangular

Part Number	Description	Weight
CLSS01	2400 x 1200 x 187mm	45kg
CLSS02	2400 x 600 x 187mm	28kg
CLSS13	1800 x 600 x 187mm	32kg
CLSS31	1800 x 1200 x 187mm	36kg
CLSS07	1200 x 1200 x 187mm	26kg
CLSS15	1200 x 600 x 187mm	15kg
CLSS32	600 x 600 x 187mm	9kg

STAGE DECK SIZES - Semi Circular

Part Number	Description	Weight
CLSS37	1200 x 600 x 187mm	13.5kg
CLSS38	2400 x 1200 x 187mm	39.0kg

STAGE DECK - Steps

Part Number	Description	Weight
CLSS23	1 Step - 290 x 800 (Suits 300mm Deck)	6.5kg
CLSS24	2 Step - 290 x 800 (Suits 600mm Deck)	11.5kg
CLSS25	4 Step - 290 x 800 (Suits 900mm Deck)	21.0kg

STAGE DECK - Legs & Accessories

Part Number	Description	Weight
CLSS03	300mm Stage Deck Leg	0.74kg
CLSS04	600mm Stage Deck Leg	1.58kg
CLSS05	900mm Stage Deck Leg	2.40kg
CLSS12	1000mm Stage Deck Leg	3.22kg
CLSS16	Castor with Wheel for Stage Deck	0.80kg
CLSS29	Castor with Brake for Stage Deck	1.00kg
CLSS17	Insert for Stage Deck Leg	0.56kg
CLSS28	Stage Deck Bolts	0.08kg
CLSS30	Stage Deck Tri Wheels	0.06kg
CLSS33	Adjustable Feet 10mm x 40mm Dia. - M10	0.08kg
CLSS34	Adjustable Feet 12mm x 60mm Dia. - M12	0.08kg
CLSS35	Adjustable Feet M16 x ø125 Mild Steel	0.58kg
CLSS36	Adjustable Feet M16 x ø125 Stainless Steel	0.58kg

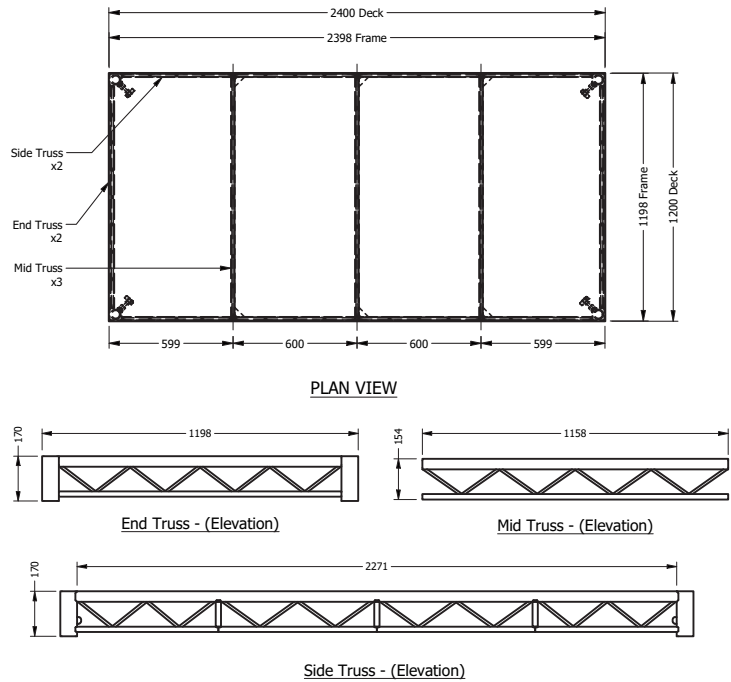

RECTANGULAR STAGE DECK



SEMI CIRCULAR STAGE DECK

*For further CLSA components and accessories please visit our website at cls.com.au
or alternatively call our office on (03) 9646 8890 to speak with one of our sales personnel

LOADING GUIDELINES

- *Loading figures are only valid for static loads.
- *Loading figures are calculated according to and in full compliance with Australian standards.
- *The self-weight of the stage deck is already taken into account